



PT. SMART CAKRAWALA AVIATION

WORK ORDER

Form: SCA/MTC/030

Subject : ELT Battery Replacement & Inspection Document 20 (ELT Functional Check) Due at January 2022	No.	WO/006-SNI/II/2022
	Date	18-February-2022
	A/C Reg.	PK-SNI C208B-5068
Reference : MP C208B Rev. 10	Prepared By	TS
	Checked By	CI
	Approved By	TM
To : Engineer In Charge		
Description : 1. Perform ELT Battery Replacement & Inspection Document 20 (ELT Functional Check) Due at January 2022 2. Make an entry in Maintenance Log. 3. Return the Completed Work Order and Form to PPC. #If any finding, please close the routine card, and transferred to inspection card.		
Additional Work : 		
Compliance Statement	Sign & Date Company Lic. No.: (Engineer In Charge)	Signature (Technical Manager)

AIRCRAFT CHECK WORK SUMMARY
(Form: SCA/MTC/051)

DATE OF ISSUED	JOWO #	TYPE OF MAINTENANCE	DATE OF ACCOMPLISHED		
18-February-2022	WO/006-SNI/II/2022	ELT Battery Replacement & Insp Doc 20 (ELT Functional Check)			
A/C Type		Mfg. Serial Number	A/C Registration		
C208B		C208B-5068	PK-SNI		
AIRCRAFT DATA					
Subject	Pos #	Serial Number (SN)	TTSN/TCSN		
Engine	#1	PCE-VA0073			
	#2	-			
Propeller/Rotor	#1	BUA29788			
	#2	-			
Landing Gear	NLG				
	LH MLG				
	RH MLG				
PACKAGE COVERED					
No	Subject	Qty	Remark		
1	Non-Routine Card	1	#001		
2	Inspection Card	1			
3	Work Order	1			
4	Summary Inspection List	1			
5	Material and Tool List	-			
6	Escalation form	-			
7	CRS (SMI / Unscheduled Maintenance)	1			
INSPECTION CARD (IC) LIST (Finding during maintenance)					
No	Taskcard Ref	Subject	Status		Name/ Sign & Stamp
			Open	Clo se	
<u>IC-001</u>					
<u>IC-002</u>					
<u>IC-003</u>					
<u>IC-004</u>					
<u>IC-005</u>					

<u>IC-006</u>					
<u>IC-007</u>					
<u>IC-008</u>					
<u>IC-009</u>					
<u>IC-010</u>					
<u>IC-011</u>					
<u>IC-012</u>					
<u>IC-013</u>					
<u>IC-014</u>					
<u>IC-015</u>					

Prepared by :
Technical Support

Checked by :
Chief Maintenance

Verified by :
Chief Inspector

Approved by :
Technical Manager

.....

.....

.....

.....



SUMMARY INSPECTION ITEMS
(Form: SCA/MTC/050)

WO Ref: WO/006-SNI/II/2022

NO.	TASK CARD NO.	DESCRIPTION	DATE	EST MHR	NAME	STAMP
1	CHAPTER 26	INSPECTION DOCUMENT 20 (ELT Functional Check)				
2	NRC-001	ELT BATTERY REPLACEMENT				



PT. SMART CAKRAWALA AVIATION

CERTIFICATE RETURN TO SERVICE

SCHEDULED MAINTENANCE INSPECTION
(CRS-SMI)

A/C TYPE : CESSNA 208B

TTSN :

A/C REG : PK-SNI

TCSN :

MSN : C208B-5068

DATE :

TYPE OF INSPECTION : INSPECTION DOCUMENT 20 (ELT Functional Check) & ADD TASK

DUE AT : JANUARY 2022

REFF : MP C208B REV. 10

EXCEPTION

AUTHORIZED PERSON

I hereby certify that this aircraft has been maintained accordance with CASR and Maintenance Program.
Aircraft safe and airworthy for flight

NAME	CAT	AMEL/OTR NO	SIGN&STAMP	DATE
	AIRFRAME & POWER PLANT			
	EIRA			

THE NEXT DUE TYPE OF INSPECTION :

DUE AT : HOURS

Form: SCA/MTC/049

	INSPECTION CARD (Form: SCA/MTC/ 048)	TECHNICAL DEPARTMENT
---	---	-------------------------

1. CARD #	2. JO/WO #	3. ORIGINATOR	4. CARD REF	5. DATE
6. A/C REG/MSN	7. A/C TYPE	8. TRADE	12. VENDOR ORDER #	
9. ZONE	10. STA	11. MTC TYPE		

13. DESCRIPTION/DEFECT-IF FINDING OF CPCP INSPECTION, PLEASE COMPLETE SET. 20	14 PPC/ENG	15 DATE

16. CORRECTIVE ACTION	17 MECH	18 ENG. LIC	19 DATE
Performed at A/C TT : A/C TC /LDG :			

20. CORROSION INFORMATION					
LOCATION	CAUSE OF DAMAGE				
	<input type="checkbox"/> Environment				
	<input type="checkbox"/> Internal Leakage				
CORROSION <input type="checkbox"/> Isolated <input type="checkbox"/> Widespread	<input type="checkbox"/> Chemical Spill				
CORROSION LVL <input type="checkbox"/> 1 <input type="checkbox"/> 2 <input type="checkbox"/> 3	<input type="checkbox"/> LAV/Galley Spill				
PROPOSED ACTION <input type="checkbox"/> Doublers	<input type="checkbox"/> Blocked Drain				
<input type="checkbox"/> Others	<input type="checkbox"/> Wet Insulation Blanket				
	<input type="checkbox"/> Other				
21. If the defect is RII, Please Sign this card finally by RII Inspector				INSP	DATE
NOTICE OF INSPECTOR					

22. PARTS REQUIRED						
PART DESCRIPTION	PART NO	QTY	SERIAL NO		STATUS	
			ON	OFF	CLOSE	OPEN

23. TOOLS REQUIRED			
DESCRIPTION	PART NO. / MODEL	NEXT CALIBRATION DATE	STATUS



MAINTENANCE PROGRAM CESSNA C208/C208B

Chapter 26 – Inspection Document 20

Reg. Mark	:	PK - _____	Date	:	_____
MSN	:	_____	Station	:	_____
TSN / CSN	:	_____	WO No.	:	_____

ITEM CODE NO.	ZONE	TASK	SIGNATURE	
			SIGN	STAMP
B256005	220 311 312 340	ARTEX C406-N Emergency Locator Transmitter (ELT) Functional Check Task 25-60-00-722		
*** End of Inspection Document 20 Items ***				

PERSONNEL PARTICIPATING IN THIS INSPECTION			
NAME	POSITION	SIGNATURE	LICENSE NUMBER

RETURN TO SERVICE

The work recorded above has been carried out in accordance with the requirements of the Civil Aviation Safety Regulation for the time being in force and in that respect the aircraft is consider fit for Release to Service.

Name	:	_____	Stamp	:	_____
Signature	:	_____	Place/Date	:	_____



NON ROUTINE CARD
(Form: SCA/MTC/047)

1. JO/WO #	2. DATE	3. MTC TYPE	4. A/C REG/MSN
WO/006-SNI/II/2022	18-Feb-2022	REPLACEMENT	PK-SNI/208B-5068
5. CARD #	6. ATA SPEC	7. TRADE	8. STA
#001	25		
9. ZONE	10. PANEL		

11. DESCRIPTION PERFORM REPLACE ELT BATTERY			
PN OFF : 452-0133 PN ON : _____			
SN OFF : 371945-014 SN ON : _____			
REFERENCE	<input checked="" type="checkbox"/> AMM Ch. 25-60-00	<input type="checkbox"/> EMM Ch	<input type="checkbox"/> OTHER
RII (*)	<input type="checkbox"/> Y	<input checked="" type="checkbox"/> N	MHR :

12. RESULT			MECH	ENG	INSP (*)
Performed at A/C TT : A/C TC /LDG :					
FINDING	<input type="checkbox"/> Y	<input type="checkbox"/> N	ACT MHR :	DATE/TIME (DD/MM/YY)	
INSPECTION CARD (IC) #					

13. PARTS REQUIRED				
DESCRIPTION	PART NO	QTY	REMARK	
			STOCK	STATUS
		1		

14. TOOLS REQUIRED			
DESCRIPTION	PART NO / MODEL	NEXT CALIBRATION DATE	STATUS

CAUTION: For Pointer 3000-1 ELT's, the remote connector must be disconnected from the ELT before you do maintenance. If the remote connector is not disconnected, it could cause the ELT's internal fuse to blow.

- (5) Put the master switch to the ON position to activate the emergency locator transmitter system.

NOTE: On Pointer 3000-11 series system, the transmitter can be activated from the cockpit by placing the remote mounted switch to ON position. Other transmitters must be activated from the tailcone mounting area.

- (6) Activate the emergency locator transmitter system for no more than three sweeps of the audio signal.
 - (a) Make sure that the signal has been detected on the AM radio.
 - (b) If the ELT does not operate correctly during the functional check, remove the transmitter and return it to an authorized avionics repair shop for inspection and repair. Refer to [Emergency Locator Transmitter System - Maintenance Practices](#).
- (7) Restore the master switch to the AUTO position.

NOTE: On Pointer 3000-11 series system, momentarily place the remote mounted switch to the RESET position then release it. This will put the transmitter in the AUTO position.
- (8) For Pointer 3000-1 ELT's, connect the remote connector to the ELT.
- (9) Make an entry in the Airplane Logbook to show that the test has been completed.

H. Restore Access

- (1) Install aft cabin partition or zip the canvas wall. Refer to [Rear Cargo Compartment Wall - Maintenance Practices](#)

END OF TASK

TASK 25-60-00-960

6. Emergency Locator Transmitter Battery Discard

A. General

- (1) This section gives the information needed to complete the discard procedures for the emergency locator transmitter battery.

B. Tools and Equipment

- (1) None

C. Access

- (1) For Artex series ELT's, open access panel [340A](#) on the right side of the vertical stabilizer to get access to the transmitter. Refer to Chapter 6, Access Plates and Panels Identification - Description and Operation.
- (2) For Dorne and Margolin, Pointer 3000-1, and Pointer 3000-11 series ELT's, remove the aft cabin partition or unzip the canvas wall to get access to the transmitter. Refer to [Rear Cargo Compartment Wall - Maintenance Practices](#).

D. Discard of the Emergency Locator Transmitter Battery.

- (1) Remove emergency locator transmitter (ELT) from the airplane.
 - (a) For the Artex C406-2 ELT, refer to [ARTEX C406-2 Emergency Locator Transmitter System - Maintenance Practices](#).
 - (b) For the Artex ME406 ELT, refer to [Artex ME406 Emergency Locator Transmitter System - Maintenance Practices](#).
 - (c) For the Artex C406-N ELT, refer to [ARTEX C406-N Emergency Locator Transmitter System - Maintenance Practices](#).
 - (d) For Dorne and Margolin, Pointer 3000-1, and Pointer 3000-11 series ELT's, refer to [Emergency Locator Transmitter System - Maintenance Practices](#).
- (2) Remove the battery pack from the ELT.
 - (a) For Artex series ELT's, refer to the applicable Artex 406MHz Emergency Locator Transmitters Description, Operation, Installation and Maintenance Manual. Refer to the Introduction, [List of Publications](#).
 - (b) For Dorne and Margolin, Pointer 3000-1, and Pointer 3000-11 series ELT's refer to [Emergency Locator Transmitter System - Maintenance Practices](#).
- (3) Install a new battery pack in the ELT.
 - (a) For Artex series ELT's, refer to the applicable Artex 406MHz Emergency Locator Transmitters Description, Operation, Installation and Maintenance Manual. Refer to the Introduction, [List of Publications](#).

- (b) For Dorne and Margolin, Pointer 3000-1, and Pointer 3000-11 series refer to [Emergency Locator Transmitter System - Maintenance Practices](#).
- (4) Install the emergency locator transmitter in the airplane.
 - (a) For the Artex C406-2 ELT, refer to [ARTEX C406-2 Emergency Locator Transmitter System - Maintenance Practices](#).
 - (b) For the Artex ME406 ELT, refer to [Artex ME406 Emergency Locator Transmitter System - Maintenance Practices](#).
 - (c) For the Artex C406-N ELT, refer to [ARTEX C406-N Emergency Locator Transmitter System - Maintenance Practices](#).
 - (d) For Dorne and Margolin, Pointer 3000-1, and Pointer 3000-11 series ELT's, refer to [Emergency Locator Transmitter System - Maintenance Practices](#).
- (5) Make an entry in the Airplane Logbook to show the battery pack replacement date and the next expiration date. The new battery expiration date can be put on a label on the face of the transmitter.

E. Restore Access

- (1) For Artex series ELT's, close access panel [340A](#). Refer to Chapter 6, Access Plates and Panels Identification - Description and Operation.
- (2) For Dorne and Margolin, Pointer 3000-1, and Pointer 3000-11 series ELT's, install the aft cabin partition or zip the canvas wall. Refer to [Rear Cargo Compartment Wall - Maintenance Practices](#).

END OF TASK

Figure 601 : Sheet 1 : Artex ME406 Emergency Locator Transmitter (ELT) SARSAT Test Set-up

A64136

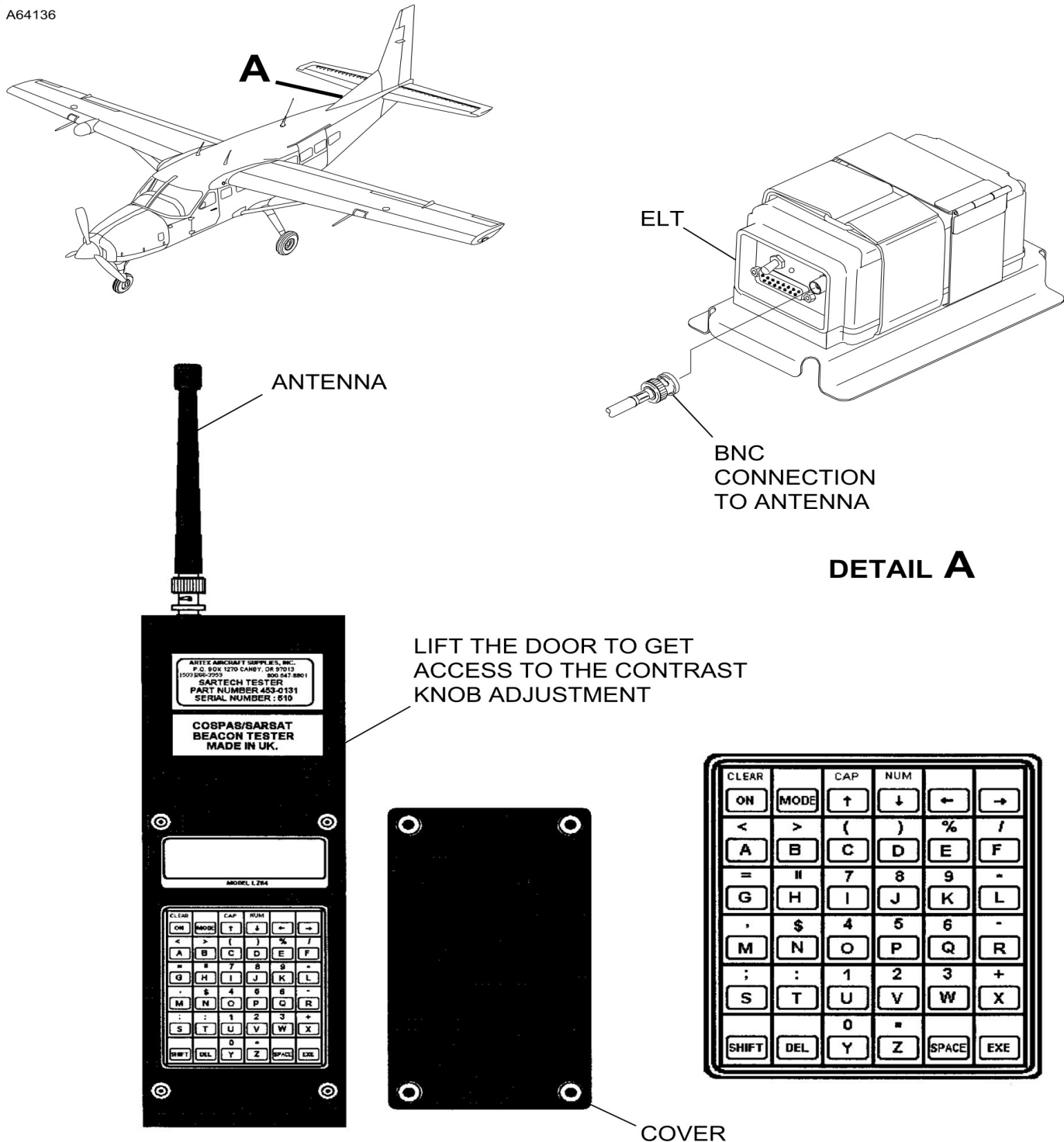

2610T7005
A2618T1386
6618T1379

Figure 601 : Sheet 2 : Artex ME406 Emergency Locator Transmitter (ELT) SARSAT Test Set-up

A64137

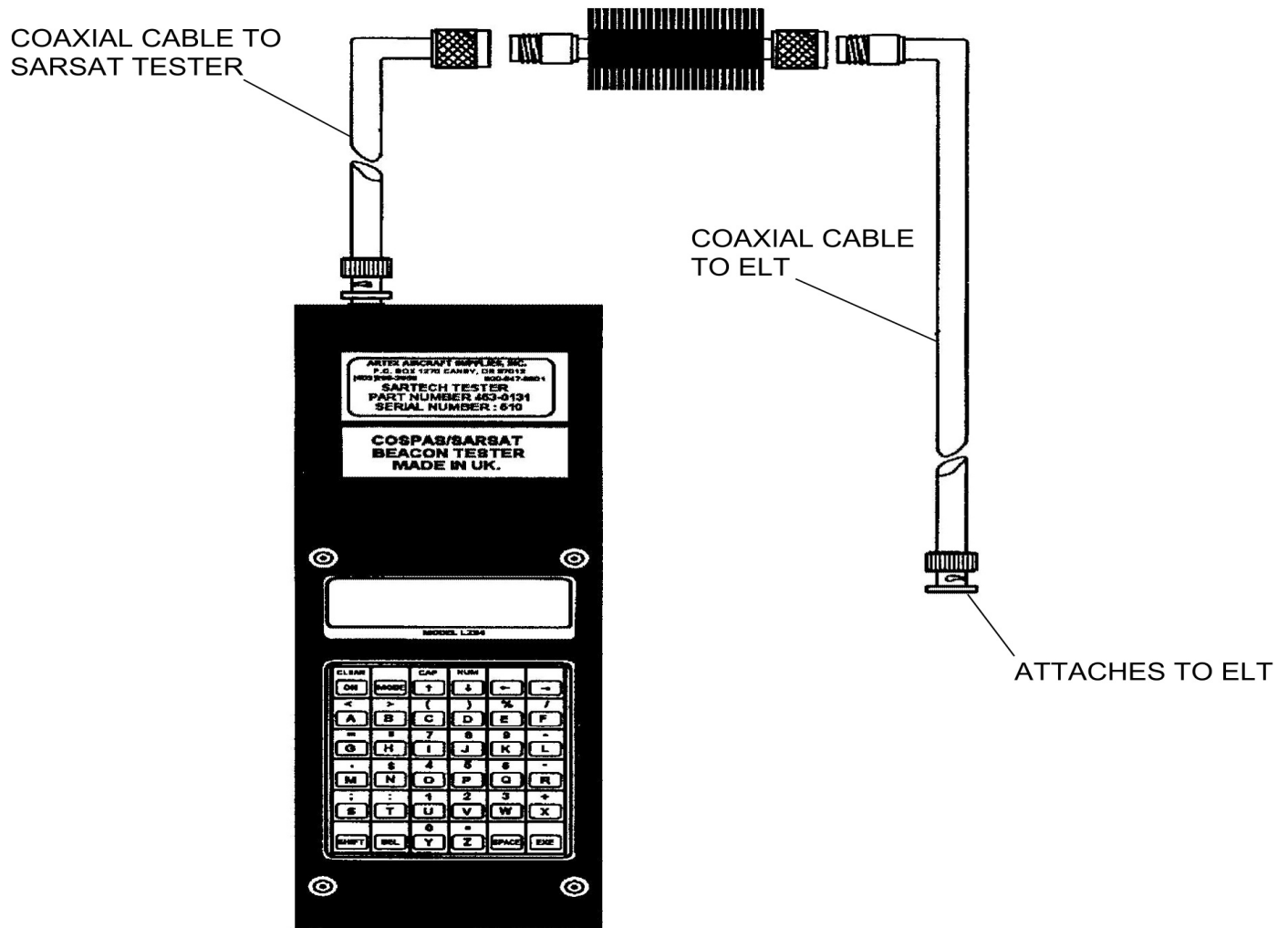

6618R1380

Figure 602 : Sheet 1 : ARTEX C406-N Emergency Locator Transmitter (ELT) SARSAT Test Set-up

A67013

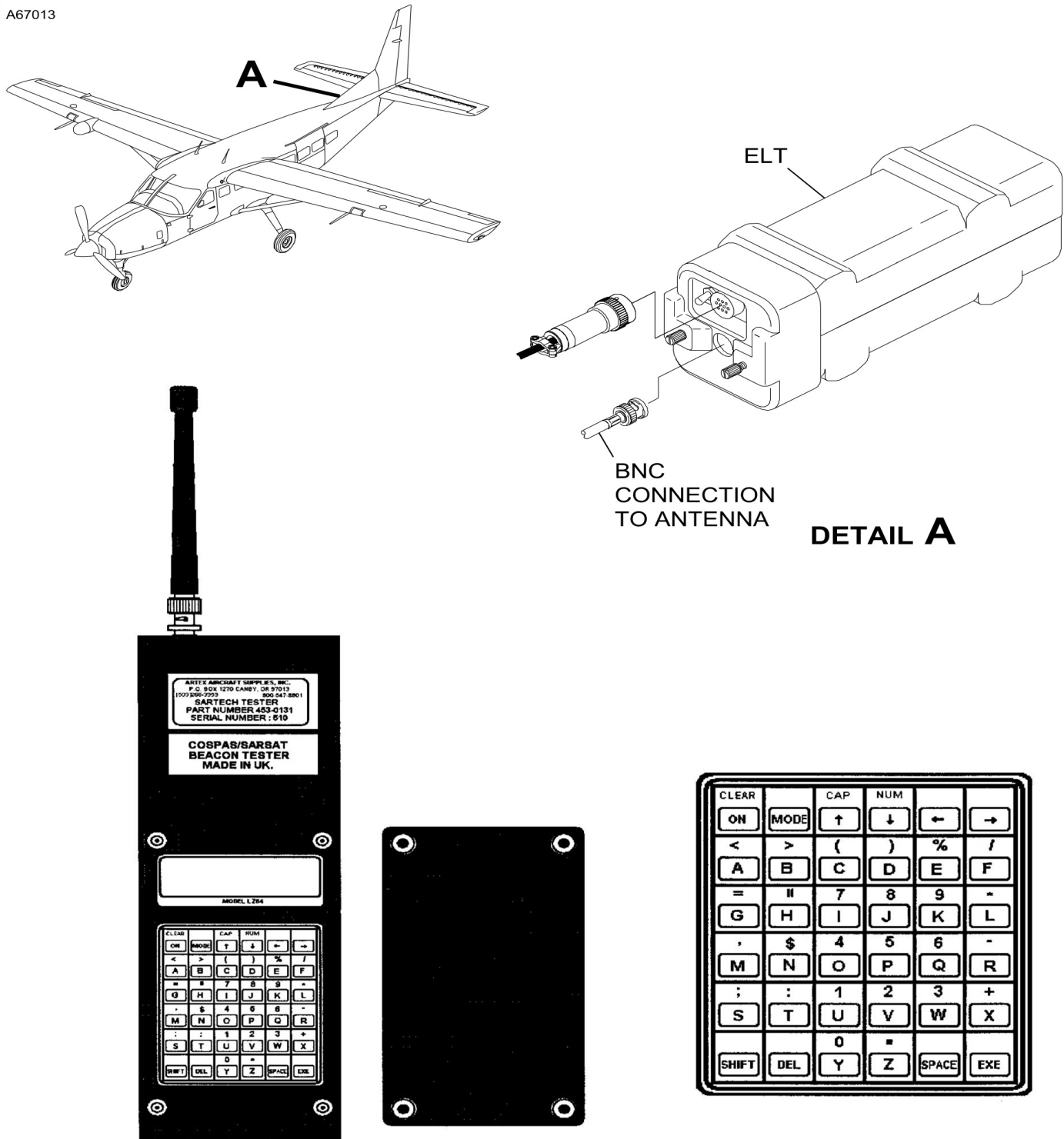

2610T7005
A5618T1589
6618T1379

Figure 9 : Sheet 1 : Aft Fuselage, Horizontal and Vertical Stabilizer Panels

A22967

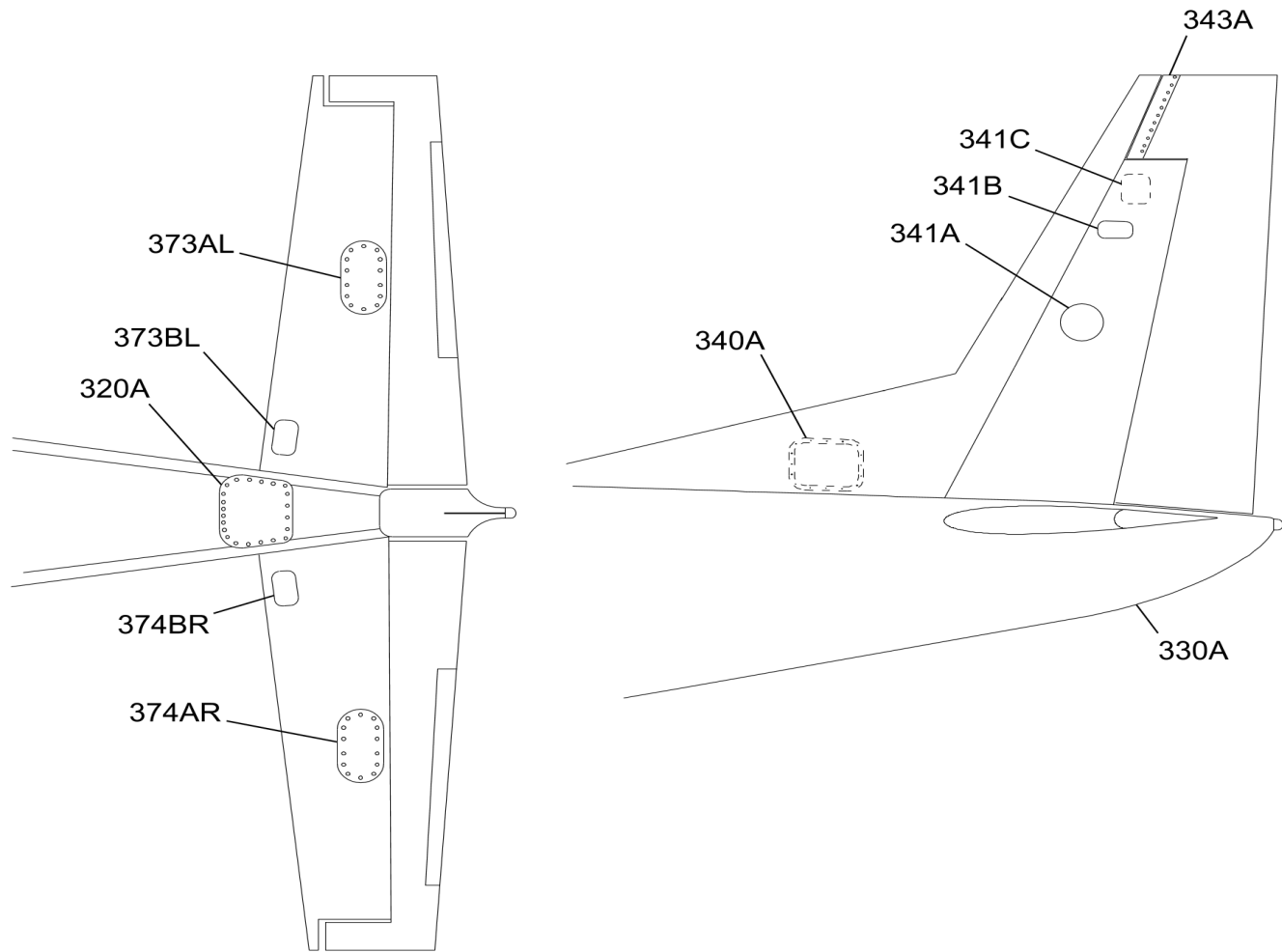

VIEW LOOKING UP AT TAILCONE

2610T1009



Additional Work Sheet

Inspection Doc. 20 & Add Task

Aircraft Registration: **PK-SNI**

WO# Nr: **WO/006-SNI/II/2022**

Parts Used Sheet

—

Special Tool Used

[illegible]

Part Used

[illegible]



Additional Work Sheet

Inspection Doc. 20 & Add Task

Aircraft Registration: **PK-SNI**

WO# Nr: WO/006-SNS/II/2022

Parts Used Sheet

2

Part Used

[illegible]