



PT. SMART CAKRAWALA AVIATION

WORK ORDER

Form: SCA/MTC/030

Subject : Inspection Documen 20 (ELT Functional Check) due at February 2022	No.	WO/088-SNP/II/2022
	Date	04-Feb-2022
	A/C Reg.	PK-SNP C208B-5495
Reference : MP C208B REV. 10	Prepared By	TS
	Checked By	CI
	Approved By	TM
To : Engineer In Charge		
Description : <ol style="list-style-type: none">1. Perform Inspection Documen 20 (ELT Functional Check) due at February 2022.2. Make an entry in Maintenance Log.3. Return the Completed Work Order and Form to PPC. <p>#If any finding, please close the routine card, and transferred to inspection card.</p>		
Additional Work :		
Compliance Statement	Sign & Date Company Lic. No.: (Engineer In Charge)	Signature (Technical Manager)

AIRCRAFT CHECK WORK SUMMARY
(Form: SCA/MTC/051)

DATE OF ISSUED	JO/WO #	TYPE OF MAINTENANCE	DATE OF ACCOMPLISHED		
04-Feb-2022	WO/088-SNP/II/2022	Inspection Doc. 20 (ELT Functional Check)			
A/C Type		Mfg. Serial Number	A/C Registration		
C208B		C208B-5495	PK-SNP		
AIRCRAFT DATA					
Subject	Pos #	Serial Number (SN)	TTSN/TCSN		
Engine	#1	PCE-VA0723			
	#2	-			
Propeller/Rotor	#1	181158			
	#2	-			
Landing Gear	NLG				
	LH MLG				
	RH MLG				
PACKAGE COVERED					
No	Subject	Qty	Remark		
1	Non-Routine Card	-			
2	Inspection Card	1			
3	Work Order	1			
4	Summary Inspection List	1			
5	Material and Tool List	-			
6	Escalation form	-			
7	CRS (SMI / Unscheduled Maintenance)	1			
INSPECTION CARD (IC) LIST (Finding during maintenance)					
No	Taskcard Ref	Subject	Status		Name/ Sign & Stamp
			Open	Close	
<u>IC-001</u>					
<u>IC-002</u>					
<u>IC-003</u>					
<u>IC-004</u>					
<u>IC-005</u>					

<u>IC-006</u>					
<u>IC-007</u>					
<u>IC-008</u>					
<u>IC-009</u>					
<u>IC-010</u>					
<u>IC-011</u>					
<u>IC-012</u>					
<u>IC-013</u>					
<u>IC-014</u>					
<u>IC-015</u>					

Prepared by :
Technical Support

Checked by :
Chief Maintenance

Verified by :
Chief Inspector

Approved by :
Technical Manager

.....

.....

.....

.....



SUMMARY INSPECTION ITEMS
(Form: SCA/MTC/050)

WO Ref: WO/088-SNP/II/2022

NO.	TASK CARD NO.	DESCRIPTION	DATE	EST MHR	NAME	STAMP
1	CHAPTER 26	INSPECTION DOCUMENT 20 (ELT Functional Check)				



PT. SMART CAKRAWALA AVIATION

CERTIFICATE RETURN TO SERVICE

SCHEDULED MAINTENANCE INSPECTION (CRS-SMI)

A/C TYPE : CESSNA 208B

TTSN :

A/C REG : PK-SNP

TCSN :

MSN : C208B-5495

DATE :

TYPE OF INSPECTION : INSPECTION DOCUMENT 20 (ELT Functionl Check)

DUE AT : 28 February 2022

REF : MP C208B REV. 10

EXCEPTION

AUTHORIZED PERSON

I hereby certify that this aircraft has been maintained accordance with CASR and Maintenance Program.
Aircraft safe and airworthy for flight

NAME	CAT	AMEL/OTR NO	SIGN&STAMP	DATE
	AIRFRAME & POWER PLANT			
	EIRA			

THE NEXT DUE TYPE OF INSPECTION :

DUE AT :

Form: SCA/MTC/049

	INSPECTION CARD (Form: SCA/MTC/ 048)	TECHNICAL DEPARTMENT
---	---	-------------------------

1. CARD #	2. JO/WO #	3. ORIGINATOR	4. CARD REF	5. DATE
6. A/C REG/MSN	7. A/C TYPE	8. TRADE	12. VENDOR ORDER #	
9. ZONE	10. STA	11. MTC TYPE		

13. DESCRIPTION/DEFECT-IF FINDING OF CPCP INSPECTION, PLEASE COMPLETE SET. 20	14 PPC/ENG	15 DATE

16. CORRECTIVE ACTION	17 MECH	18 ENG. LIC	19 DATE
Performed at A/C TT : A/C TC /LDG :			

20. CORROSION INFORMATION					
LOCATION	CAUSE OF DAMAGE				
	<input type="checkbox"/> Environment				
	<input type="checkbox"/> Internal Leakage				
CORROSION <input type="checkbox"/> Isolated <input type="checkbox"/> Widespread	<input type="checkbox"/> Chemical Spill				
CORROSION LVL <input type="checkbox"/> 1 <input type="checkbox"/> 2 <input type="checkbox"/> 3	<input type="checkbox"/> LAV/Galley Spill				
PROPOSED ACTION <input type="checkbox"/> Doublers	<input type="checkbox"/> Blocked Drain				
<input type="checkbox"/> Others	<input type="checkbox"/> Wet Insulation Blanket				
.....	<input type="checkbox"/> Other				
21. If the defect is RII, Please Sign this card finally by RII Inspector				INSP	DATE
NOTICE OF INSPECTOR					

22. PARTS REQUIRED						
PART DESCRIPTION	PART NO	QTY	SERIAL NO		STATUS	
			ON	OFF	CLOSE	OPEN

23. TOOLS REQUIRED			
DESCRIPTION	PART NO. / MODEL	NEXT CALIBRATION DATE	STATUS



MAINTENANCE PROGRAM CESSNA C208/C208B

Chapter 26 – Inspection Document 20

Reg. Mark	:	PK -	Date	:	
MSN	:		Station	:	
TSN / CSN	:		WO No.	:	

ITEM CODE NO.	ZONE	TASK	SIGNATURE	
			SIGN	STAMP
B256005	220 311 312 340	ARTEX C406-N Emergency Locator Transmitter (ELT) Functional Check Task 25-60-00-722		
*** End of Inspection Document 20 Items ***				

PERSONNEL PARTICIPATING IN THIS INSPECTION			
NAME	POSITION	SIGNATURE	LICENSE NUMBER

RETURN TO SERVICE

The work recorded above has been carried out in accordance with the requirements of the Civil Aviation Safety Regulation for the time being in force and in that respect the aircraft is considered fit for Release to Service.

Name	:		Stamp	:	
Signature	:		Place/Date	:	

- (4) Put the ELT remote switch (SZ09) in the ON position for approximately 1 second .
- (5) Make sure that the ELT signal is heard through the cockpit speakers and that the LED adjacent to the switch is on.
- (6) Immediately put the ELT remote switch in the ARM position.
- (7) Make sure that the LED stays on for approximately 1 second before it is turned off.
- (8) If the ELT system has sensed a fault in the system, the LED will flash a fault code at this time.
 - (a) For information on the possible codes, refer to the Installation and Operation Manual for the Artex C406-2 system.

H. Do a NAV Interface Test.

- (1) If necessary put the airplane in the test configuration. Refer to [Put the Airplane in the Test Configuration](#) in this section.
- (2) After a minimum of 60 seconds, engage the ELT/NAV circuit breaker circuit breaker on the cockpit circuit breaker panel.
- (3) Use a 30-dB load to connect the SARSAT Tester to the 406.025 MHz coax cable at the base of the antenna.

NOTE: The SARSAT test set is held no more than six inches away from the antenna.

- (4) Turn on the SARSAT tester.
- (5) Engage the receive function of the SARSAT tester.
 - (a) Make sure that the display on the tester shows that it is searching for a signal.

CAUTION: Operate the emergency locator transmitter system only during the first five minutes of each hour. If the functional test must be completed at a time other than the first five minutes of the hour, the nearest FAA tower or Flight Service Station must be told of the test in accordance with FAA Advisory Circular AC-91-44A.

CAUTION: Do not operate the emergency locator transmitter for more than 15 seconds at a time. Also, the ELT must be off for at least 60 seconds between each 15 second activation cycle. During the first 15 seconds of transmission, the satellite system will receive the 406.025 MHz signal as a test signal. If the signal continues for more than 15 seconds, the signal will be identified as a distress signal.

- (6) Put the ELT remote switch (SZ09), on the right switch panel, in the ON position.
- (7) Within 15 seconds put the ELT remote switch in the ARM position.
- (8) Monitor the SARSAT tester to see if it received a signal from the ELT system.
 - (a) If a signal was not received, the cycle can be completed again after the 60-second off cycle.
- (9) Make sure that the tail number shown on the SARSAT tester is correct.

NOTE: When ownership of an aircraft is transferred within the same country, the C406-2 ELT must be registered with the applicable authority. When an aircraft with a C406-2 ELT changes tail number or country registration, the ELT must have the new identification data entered. The ELT must be registered with the applicable authority.

- (10) Make sure that the Mode S code shown on the SARSAT tester is the same as the number found on the back of the transmitter.
- (11) Make sure that the latitude and longitude information is the same as that shown on the FMS display.
- (12) Turn the SARSAT tester off.
- (13) Disconnect the 30 dB load and SARSAT tester from the 406.025 MHz antenna cable.
- (14) Connect the coaxial cable to the antenna.
- (15) If no other tests are necessary, do the steps that follow:
 - (a) Put the avionics switch in the OFF position.
 - (b) Put the battery switch in the OFF position.
 - (c) Remove the external electrical power from the airplane.

I. Restore Access

- (1) Close access panel [340A](#) on the right side of the vertical stabilizer. Refer to Chapter 6, Access Plates and Panels Identification - Description and Operation.

END OF TASK

TASK 25-60-00-721

3. Artex ME406 Emergency Locator Transmitter (ELT) Functional Check

A. General

- (1) This task gives the procedures to do a functional check of the Artex ME406 Emergency Locator Transmitter (ELT).

B. Special Tools

- (1) 50 Ohm Dummy Load
- (2) Amplitude Modulation (AM) Receiver
- (3) Attenuator (30 dB)
- (4) SRSAT Tester

C. Access

- (1) Open access panel 340A on the right side of the vertical stabilizer. Refer to Chapter 6, Access Plates and Panels Identification - Description and Operation.

D. Do an inspection of the ELT, mounting tray, antenna, and the ELT battery for condition and correct installation.

- (1) Make sure that the ELT switch, found on the forward end of the ELT, is set to the ARM position.
- (2) Remove the ELT from the mounting tray. Refer to [Artex ME406 Emergency Locator Transmitter System - Maintenance Practices](#).

CAUTION: Do not use solvents to clean the ELT, mounting tray, or electrical contacts. Solvents used in these areas can cause damage to the ELT housing.

- (3) Examine the ELT and the mounting tray for correct installation, cleanliness, cracks, or other damage.
- (4) Examine the ELT battery for corrosion.
- (5) Look at the battery expiration date.
 - (a) Make sure that the battery life limit is not expired.
 - (b) Make sure that the battery expiration date is shown correctly in the Maintenance Records.

NOTE: The battery manufacturer puts a mark on the battery to show the battery life limit. When you install a new battery in an ELT, make sure a record of the expiration date is put in the space given on the ELT name and data plate.
 - (c) If you have to replace the ELT battery, refer to Artex Maintenance Manual 570-1600.
 - (d) You must replace the ELT battery with a new battery if one or more of the conditions that follow occur:
 - Use of the ELT battery in an emergency
 - Operation for an unknown amount of time
 - Use for more than one hour of cumulative time
 - Replacement date shown on the battery label has expired or will expire before the next scheduled inspection.
 - (e) Record the new battery expiration date in the maintenance log if you replaced it.
- (6) Examine the ELT antenna for correct installation and cracks or other damage.

E. Do a G-Switch Operational Test.

NOTE: If possible, do the test procedure for the emergency locator transmitter inside a metal hangar with the doors closed to decrease the signal transmission from the ELT unit during the test.

CAUTION: Operate the Emergency Locator Transmitter (ELT) system only during the first five minutes of each hour. If you must complete the functional test at a time other than the first five minutes of the hour, you must do the test with a direct connection to the ELT and a 30 dB attenuator. Refer to the FAA Advisory Circular AC-91-44A.

CAUTION: Do not operate the Emergency Locator Transmitter (ELT) for more than five seconds at a time. Do not operate the ELT again for 15 seconds. The ELT will transmit a 406.028 MHz distress signal after it is activated for approximately 50 seconds.

- (1) Install a jumper wire between pins 5 and 12 on the electrical connector of the ELT.

CAUTION: It is recommended that an experienced technician do this procedure because of the potential physical damage that can occur if the jumper wire is not installed correctly.

NOTE: The ELT will not activate with the G-switch unless electrical pins 5 and 12 have a jumper wire installed between them (this happens automatically when the ELT is locked into the mount tray).

with the electrical connector in position).

- (2) Make sure the ELT switch is in the ARM position.
- (3) Use a amplitude modulation (AM) receiver and set it to 121.5 MHz to listen for the aural warning sweep tone.
- (4) Hold the ELT transmitter tightly in one hand and make a throwing movement followed by an opposite movement of the ELT transmitter.
- (5) Make sure that the G-switch operates and that the aural warning sweep tone is heard on the AM receiver set to 121.5 MHz.
- (6) Set the ELT switch to the ON position and then back to the ARM position to reset the G-switch.
- (7) Remove the jumper wire from electrical pins 5 and 12 on the electrical connector of the ELT.
- (8) Install the emergency locator transmitter in the airplane. Refer to [Artex ME406 Emergency Locator Transmitter System - Maintenance Practices](#).

F. Transmitter Test of the Artex ME406 Emergency Locator Transmitter (ELT) System.

CAUTION: Operate the Emergency Locator Transmitter (ELT) system only during the first five minutes of each hour. If you must complete the functional test at a time other than the first five minutes of the hour, you must do the test with a direct connection to the ELT and a 30 dB attenuator. Refer to the FAA Advisory Circular AC-91-44A.

CAUTION: Do not operate the Emergency Locator Transmitter (ELT) for more than five seconds at a time. Do not operate the ELT again for 15 seconds. The ELT will transmit a 406.028 MHz distress signal after it is activated for approximately 50 seconds.

- (1) Make sure the BATTERY switch and the AVIONICS switches are in the OFF position.
- (2) Connect external electrical power to the airplane.
- (3) Make sure that the COM/NAV 1 and AUD/MKR circuit breakers on the circuit breaker panel are engaged.
- (4) Set the BATTERY switch to the ON position.
- (5) Set the AVIONICS switches to the ON position.
- (6) Make sure that the ELT remote switch on the right panel is in the ARM position.
- (7) Set one of the communication units to receive a frequency of 121.5 MHz.
- (8) Set the communication unit to the airplane speakers at an audio level loud enough to be heard.

NOTE: The SARSAT tester is used as an example to gather test information. However, other equivalent test equipment such as the Aeroflex IFR 4000 Communications Test Set is acceptable.

- (9) Have another person use the SARSAT tester set to the RECV function. Refer to [Figure 601](#).

NOTE: The SARSAT tester must be less than 15 feet from the ELT antenna and must have a line-of-sight between the ELT antenna and SARSAT tester.

NOTE: The person with the SARSAT tester must make sure that the ELT buzzer is heard during the test.

NOTE: If it is necessary to do the transmitter test after the first five minutes of the hour, the SARSAT tester is connected directly to the ELT with a coaxial cable and a 30 dB attenuator. You will not hear the sweep tone from the ELT on the airplane speakers with the attenuator installed.

- (10) Install the 30 dB attenuator between the ELT and SARSAT tester if necessary.
- (11) Set the ELT remote switch on the right panel to the ON position.
- (12) Let the ELT make three sweeps on the airplane speakers.

NOTE: This will take one second. The ELT remote switch will start to flash.

- (13) Set the ELT remote switch back to the ARM position and monitor the LED.

NOTE: The ELT will do a self-test. The LED will stay on for one second and the ELT sweeps are not audible on the airplane speakers if the ELT operation is normal.

NOTE: The ELT does not transmit a 406.028 MHz test signal to the SARSAT tester until the ELT remote switch is set back to the ARM position.

- (14) If the LED continues to flash, refer to [Artex ME406 Emergency Locator Transmitter System - Troubleshooting](#).
- (15) If the SARSAT tester did not receive a 406.028 MHz signal and the ELT remote switch LED does not show a transmitter problem, do the test again.

(16) When the SARSAT tester receives a 406.028 MHz signal, scroll the pages on the tester, as necessary, and make sure of the information that follows:

(a) Make sure the information shown by the SARSAT tester agrees with the placard on the ELT.

NOTE: The information that follows must match the data on the ELT placard:

- COUNTRY code
- 15-digit Hex code ID
- Aircraft identification number.

(b) Make sure that the SARSAT tester shows the messages that follow:

- S' TEST OK
- Frequency - PASS
- Homing frequency
- Message format (short).

NOTE: When ownership of an aircraft is transferred within the same country, the ME406 ELT should be registered with the applicable authority. When an aircraft with a ME406 ELT changes tail number or country registration, the ELT will need to have the new identification data entered. The ELT will also need to be registered with the applicable authority.

G. Restore Access

(1) Close access panel [340A](#). Refer to Chapter 6, Access Plates and Panels Identification - Description and Operation.

END OF TASK

TASK 25-60-00-722

4. ARTEX C406-N Emergency Locator Transmitter (ELT) Functional Check

A. General

(1) This task gives the procedures to do a functional check of the Artex C406-N Emergency Locator Transmitter (ELT).

B. Special Tools

- (1) 50 Ohm Dummy Load
- (2) Amplitude Modulation (AM) Receiver
- (3) Attenuator (30 dB)
- (4) SARSAT Tester

C. Access

(1) Open access panel [340A](#) on the right side of the vertical stabilizer. Refer to Chapter 6, Access Plates and Panels Identification - Description and Operation.

D. Do an inspection of the ELT, mounting tray, antenna, and the ELT battery for condition and correct installation.

- (1) Make sure that the ELT switch, found on the forward end of the ELT, is set to the OFF position.
- (2) Remove the ELT from the mounting tray. Refer to [ARTEX C406-N Emergency Locator Transmitter System - Maintenance Practices](#).

CAUTION: Do not use solvents to clean the ELT, mounting tray, or electrical contacts. Solvents used in these areas can cause damage to the ELT housing.

- (3) Examine the ELT and the mounting tray for correct installation, cleanliness, cracks, or other damage.
- (4) Examine the ELT battery for corrosion.
- (5) Look at the battery expiration date.

- (a) Make sure that the battery life limit is not expired.
- (b) Make sure that the battery expiration date is shown correctly in the maintenance records.

NOTE: The battery manufacturer puts a mark on the battery to show the battery life limit. When you install a new battery in an ELT, make sure that you make a record of the expiration date in the space given on the ELT name and data plate.

- (c) If you have to replace the ELT battery, refer to ARTEX Maintenance Manual 570-5060.
- (d) You must replace the ELT battery with a new battery if one or more of the conditions that follow occur:

CAUTION: For Pointer 3000-1 ELT's, the remote connector must be disconnected from the ELT before you do maintenance. If the remote connector is not disconnected, it could cause the ELT's internal fuse to blow.

- (5) Put the master switch to the ON position to activate the emergency locator transmitter system.

NOTE: On Pointer 3000-11 series system, the transmitter can be activated from the cockpit by placing the remote mounted switch to ON position. Other transmitters must be activated from the tailcone mounting area.

- (6) Activate the emergency locator transmitter system for no more than three sweeps of the audio signal.
 - (a) Make sure that the signal has been detected on the AM radio.
 - (b) If the ELT does not operate correctly during the functional check, remove the transmitter and return it to an authorized avionics repair shop for inspection and repair. Refer to [Emergency Locator Transmitter System - Maintenance Practices](#).
- (7) Restore the master switch to the AUTO position.

NOTE: On Pointer 3000-11 series system, momentarily place the remote mounted switch to the RESET position then release it. This will put the transmitter in the AUTO position.
- (8) For Pointer 3000-1 ELT's, connect the remote connector to the ELT.
- (9) Make an entry in the Airplane Logbook to show that the test has been completed.

H. Restore Access

- (1) Install aft cabin partition or zip the canvas wall. Refer to [Rear Cargo Compartment Wall - Maintenance Practices](#)

END OF TASK

TASK 25-60-00-960

6. Emergency Locator Transmitter Battery Discard

A. General

- (1) This section gives the information needed to complete the discard procedures for the emergency locator transmitter battery.

B. Tools and Equipment

- (1) None

C. Access

- (1) For Artex series ELT's, open access panel [340A](#) on the right side of the vertical stabilizer to get access to the transmitter. Refer to Chapter 6, Access Plates and Panels Identification - Description and Operation.
- (2) For Dorne and Margolin, Pointer 3000-1, and Pointer 3000-11 series ELT's, remove the aft cabin partition or unzip the canvas wall to get access to the transmitter. Refer to [Rear Cargo Compartment Wall - Maintenance Practices](#).

D. Discard of the Emergency Locator Transmitter Battery.

- (1) Remove emergency locator transmitter (ELT) from the airplane.
 - (a) For the Artex C406-2 ELT, refer to [ARTEX C406-2 Emergency Locator Transmitter System - Maintenance Practices](#).
 - (b) For the Artex ME406 ELT, refer to [Artex ME406 Emergency Locator Transmitter System - Maintenance Practices](#).
 - (c) For the Artex C406-N ELT, refer to [ARTEX C406-N Emergency Locator Transmitter System - Maintenance Practices](#).
 - (d) For Dorne and Margolin, Pointer 3000-1, and Pointer 3000-11 series ELT's, refer to [Emergency Locator Transmitter System - Maintenance Practices](#).
- (2) Remove the battery pack from the ELT.
 - (a) For Artex series ELT's, refer to the applicable Artex 406MHz Emergency Locator Transmitters Description, Operation, Installation and Maintenance Manual. Refer to the Introduction, [List of Publications](#).
 - (b) For Dorne and Margolin, Pointer 3000-1, and Pointer 3000-11 series ELT's refer to [Emergency Locator Transmitter System - Maintenance Practices](#).
- (3) Install a new battery pack in the ELT.
 - (a) For Artex series ELT's, refer to the applicable Artex 406MHz Emergency Locator Transmitters Description, Operation, Installation and Maintenance Manual. Refer to the Introduction, [List of Publications](#).

- (b) For Dorne and Margolin, Pointer 3000-1, and Pointer 3000-11 series refer to [Emergency Locator Transmitter System - Maintenance Practices](#).
- (4) Install the emergency locator transmitter in the airplane.
 - (a) For the Artex C406-2 ELT, refer to [ARTEX C406-2 Emergency Locator Transmitter System - Maintenance Practices](#).
 - (b) For the Artex ME406 ELT, refer to [Artex ME406 Emergency Locator Transmitter System - Maintenance Practices](#).
 - (c) For the Artex C406-N ELT, refer to [ARTEX C406-N Emergency Locator Transmitter System - Maintenance Practices](#).
 - (d) For Dorne and Margolin, Pointer 3000-1, and Pointer 3000-11 series ELT's, refer to [Emergency Locator Transmitter System - Maintenance Practices](#).
- (5) Make an entry in the Airplane Logbook to show the battery pack replacement date and the next expiration date. The new battery expiration date can be put on a label on the face of the transmitter.

E. Restore Access

- (1) For Artex series ELT's, close access panel [340A](#). Refer to Chapter 6, Access Plates and Panels Identification - Description and Operation.
- (2) For Dorne and Margolin, Pointer 3000-1, and Pointer 3000-11 series ELT's, install the aft cabin partition or zip the canvas wall. Refer to [Rear Cargo Compartment Wall - Maintenance Practices](#).

END OF TASK

Figure 601 : Sheet 1 : Artex ME406 Emergency Locator Transmitter (ELT) SARSAT Test Set-up

A64136

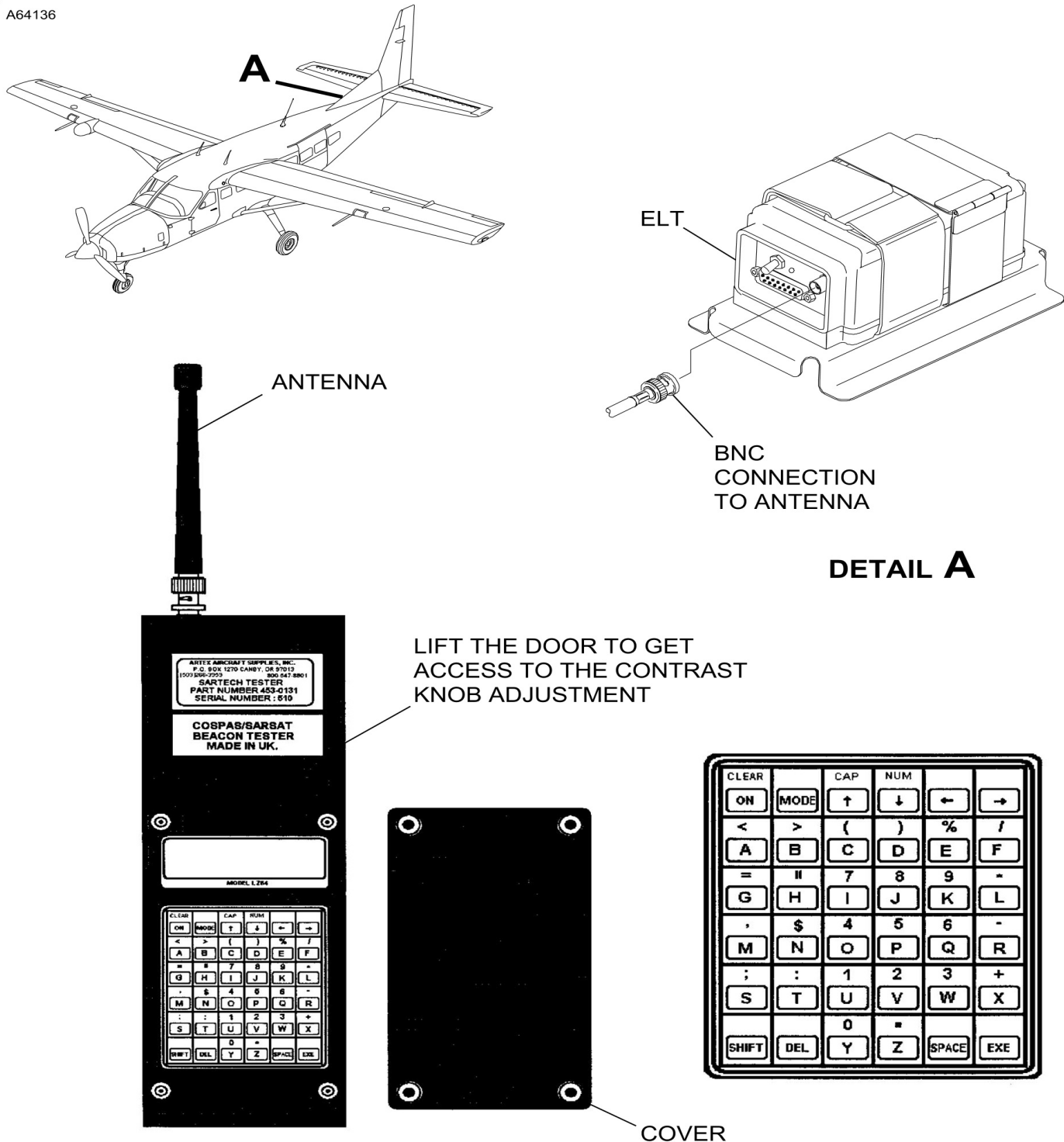

2610T7005
A2618T1386
6618T1379

Figure 601 : Sheet 2 : Artex ME406 Emergency Locator Transmitter (ELT) SARSAT Test Set-up

A64137

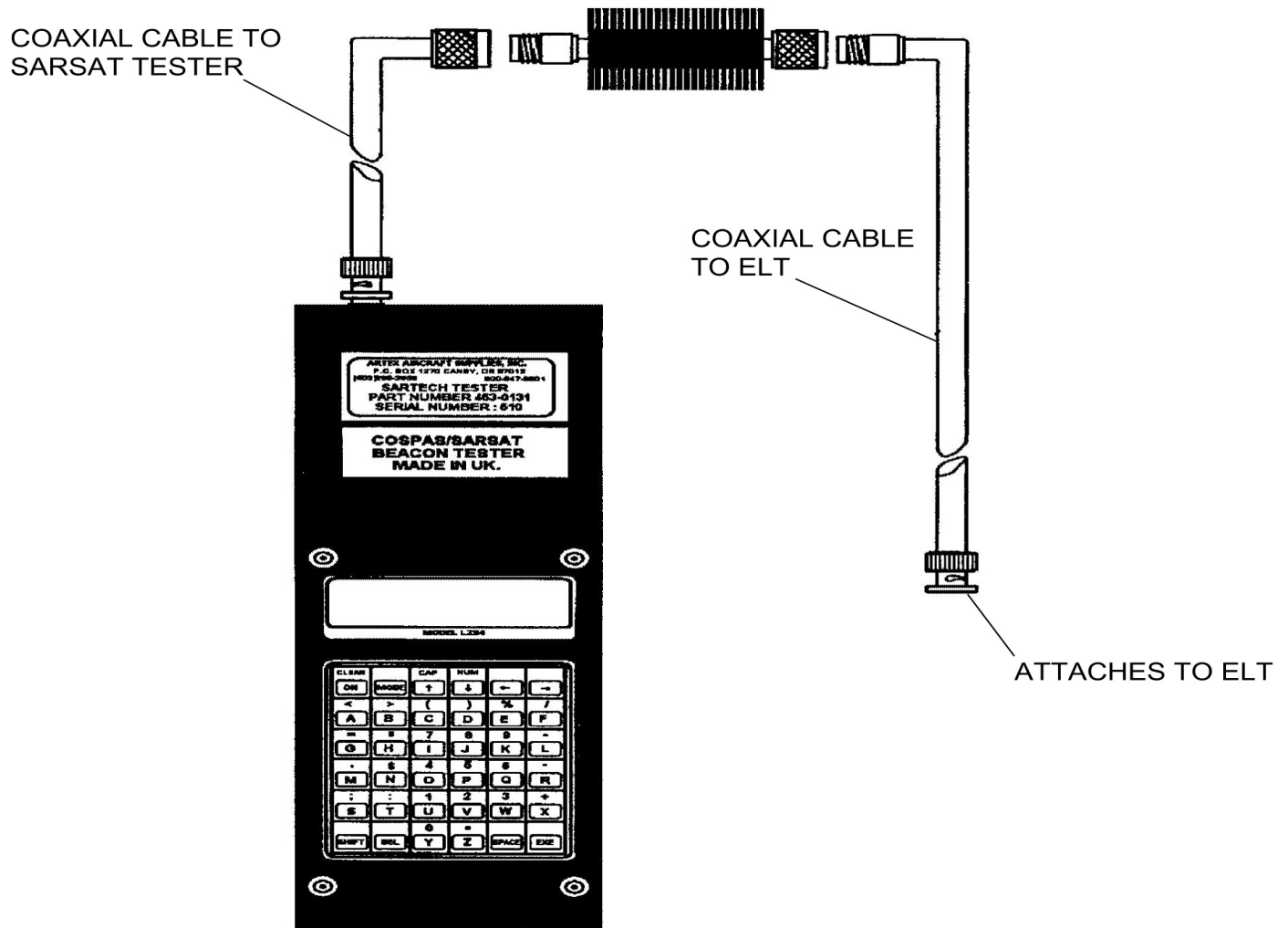

6618R1380

Figure 602 : Sheet 1 : ARTEX C406-N Emergency Locator Transmitter (ELT) SARSAT Test Set-up

A67013

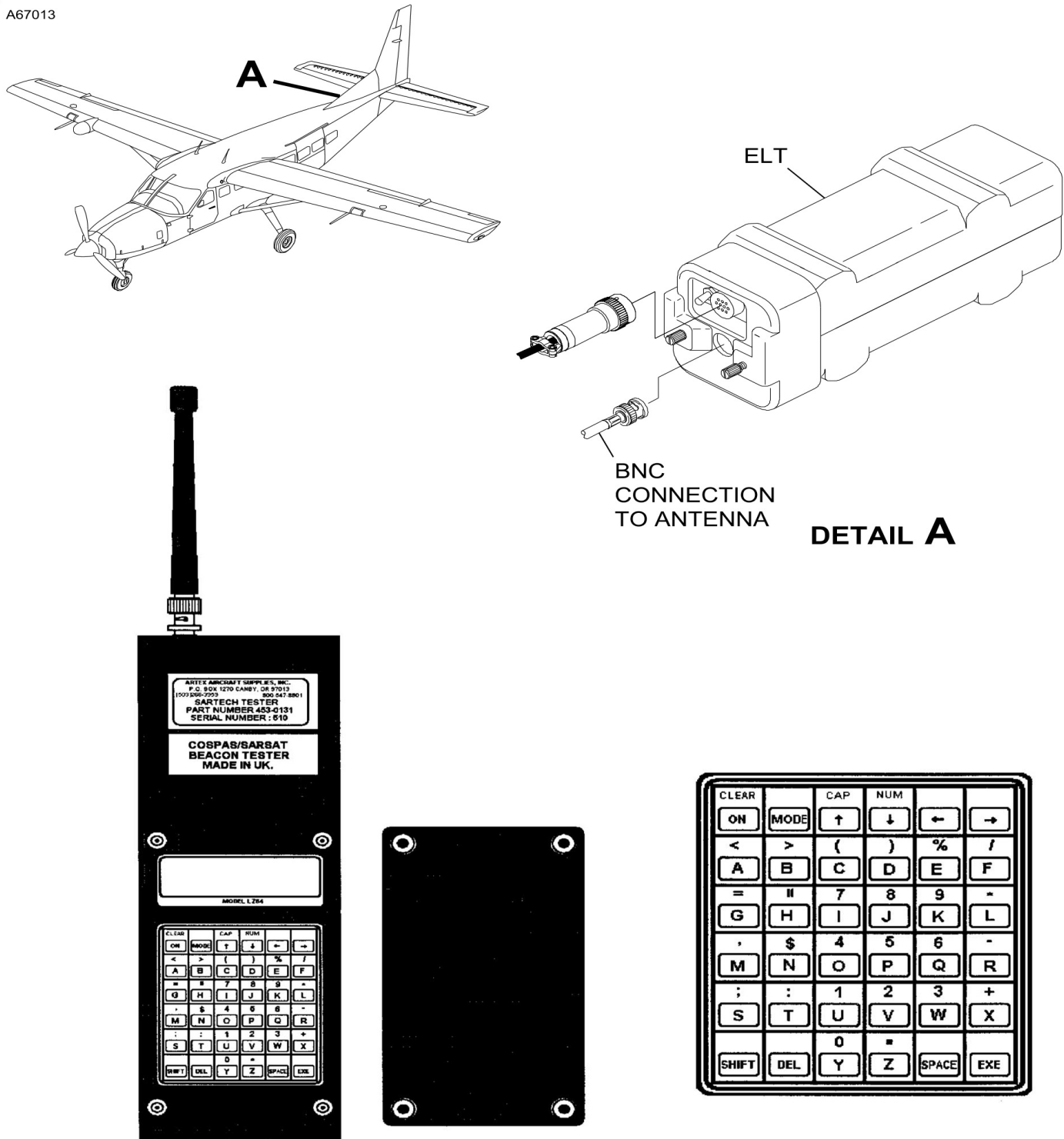

2610T7005
A5618T1589
6618T1379

Figure 9 : Sheet 1 : Aft Fuselage, Horizontal and Vertical Stabilizer Panels

A22967

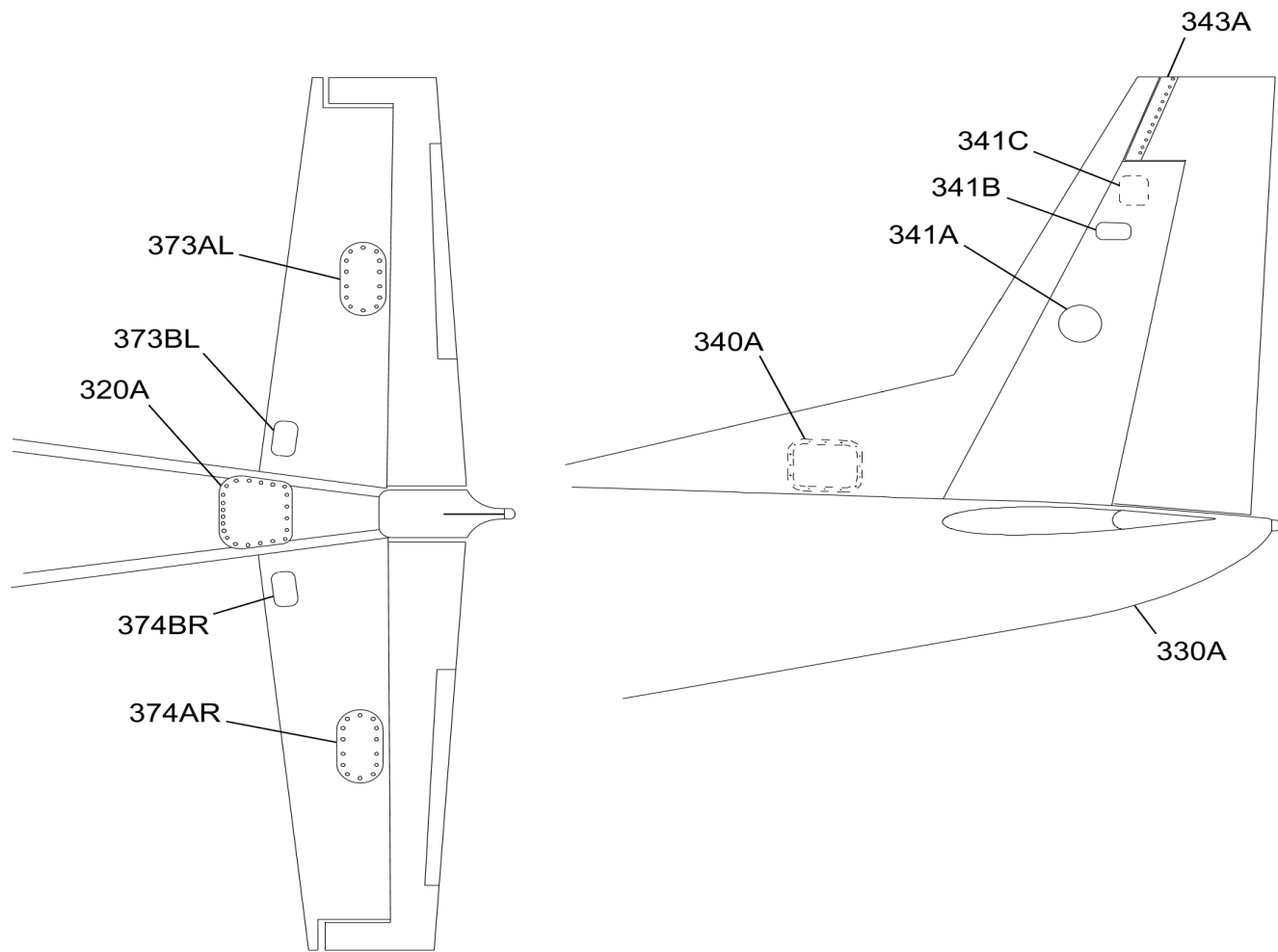

VIEW LOOKING UP AT TAILCONE

2610T1009



Additional Work Sheet

Inspection Doc. 20

(ELT Functional Check)

Aircraft Registration: **PK-SNP**

WO# Nr: **WO/088-SNP/II/2022**

Parts Used Sheet

Special Tool Used

[illegible]



Additional Work Sheet

Inspection Doc. 20

(ELT Functional Check)

Aircraft Registration: **PK-SNP**

WO# Nr: **WO/088-SNP/II/2022**

Parts Used Sheet

Part Used

[illegible]